



Interior Finish & Optional Enhancements Selections



STRATOS
RESIDENTIAL COLLECTION

Purchaser: _____ Sky Cabin # _____

Pursuant to Sections 6.f and 6.g of the Purchase and Sale Agreement for Stratos, this document shall constitute Purchaser's Interior Finish Selections and Optional Enhancements Selection Form. Purchaser shall select the desired finish package and any desired optional enhancements by checking the boxes on the following pages and delivering a signed copy to Seller via DocuSign. Interior Finish Selections and Optional Enhancements must be received and acknowledged by Seller no later than July 11, 2025 - the Finish Selections Deadline and Optional Enhancements Selection Deadline described in your PSA.

There are two carefully curated finish scheme palettes to select from. We strongly recommend that you pick one or the other in its entirety, but there are options within this form to mix schemes between bathrooms if desired.

CADENCE FINISH SCHEME



TEMPO FINISH SCHEME



Artist conceptual renderings.

Shared Finishes

Select A Finish Scheme for Finishes throughout Great Room, Kitchen and Bedrooms (from Cadence on Page 3 OR Tempo on Page 6)

Check here to Select >



WOOD FLOORING & WALL PANELING
Arrigoni Woods,
Rustic White Oak, Brushed,
Arolla - 9.5”



WOOL CARPET
Fabrica
Inclination -
Flair



WOOL CARPET
Stark Irvine -
Moccasin



**OPTIONAL
ENHANCEMENT**

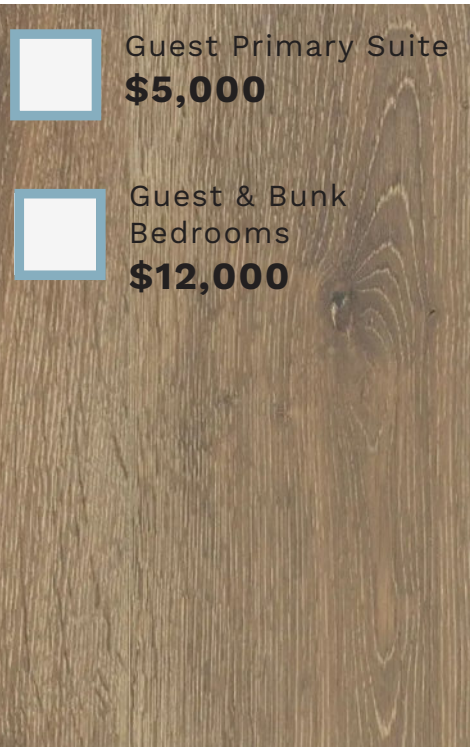

**REPLACE CARPET WITH
WOOD FLOORING**



WOOD CEILING
Arrigoni Woods -
Engineered Wood Panel
Spruce - Brushed
Natural Oil



BASEBOARD - STAINED WOOD
Straight Profile
Finish to Coordinate with Floors



MILLWORK FINISH
Poliform
Rovere Gold Oak

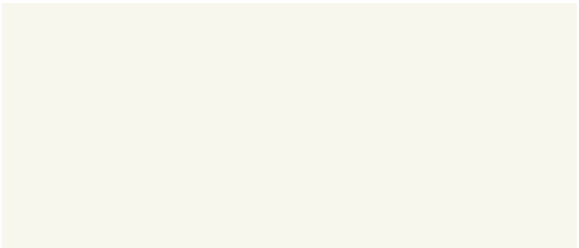

PAINT
Benjamin Moore
Cloud White
Walls - Eggshell, Ceiling - Flat



INTERIOR DOOR HARDWARE
FSB
Matte Black



DOOR STYLE
Slab Door and Extended Jamb
Character Grade White Oak,
Vertical Direction
Finish to Coordinate with
Floors & Wall Paneling



MILLWORK PANELING
Arrigoni, Rustic White Oak, Arolla

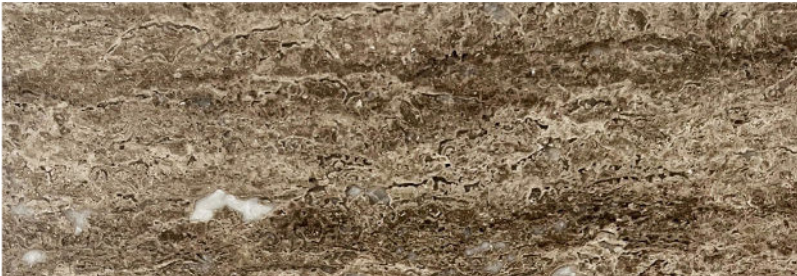

FIREPLACE STONE & HEARTH
Thorntree Didima Dark, Honed
2CM Slab



ACCENT STONE
Basaltina Honed and Filled, Basalt
3CM Slab



FIREPLACE
Dimplex Opti-Myst Pro
1000 Cassette



Elevations are examples for reference to illustrate finishes, but details vary by plan



MILLWORK FINISH
Rovere Gold Oak



STONE FLOOR TILE
Tile Bar - Catalina Belgian Bluestone
18" x 36"



QUARTZ COUNTERTOP
Fresh Concrete Honed
3CM



ENTRY COAT HOOK
RMH - Jane Hook
Silicon Bronze
Dark



WORKSTATION SINK
Ruvati - Alto Utility
Sink



FAUCET
Waterworks
Matte Brown



ENTRY FLUSH
MOUNT Allied Maker
- Dome Bronze

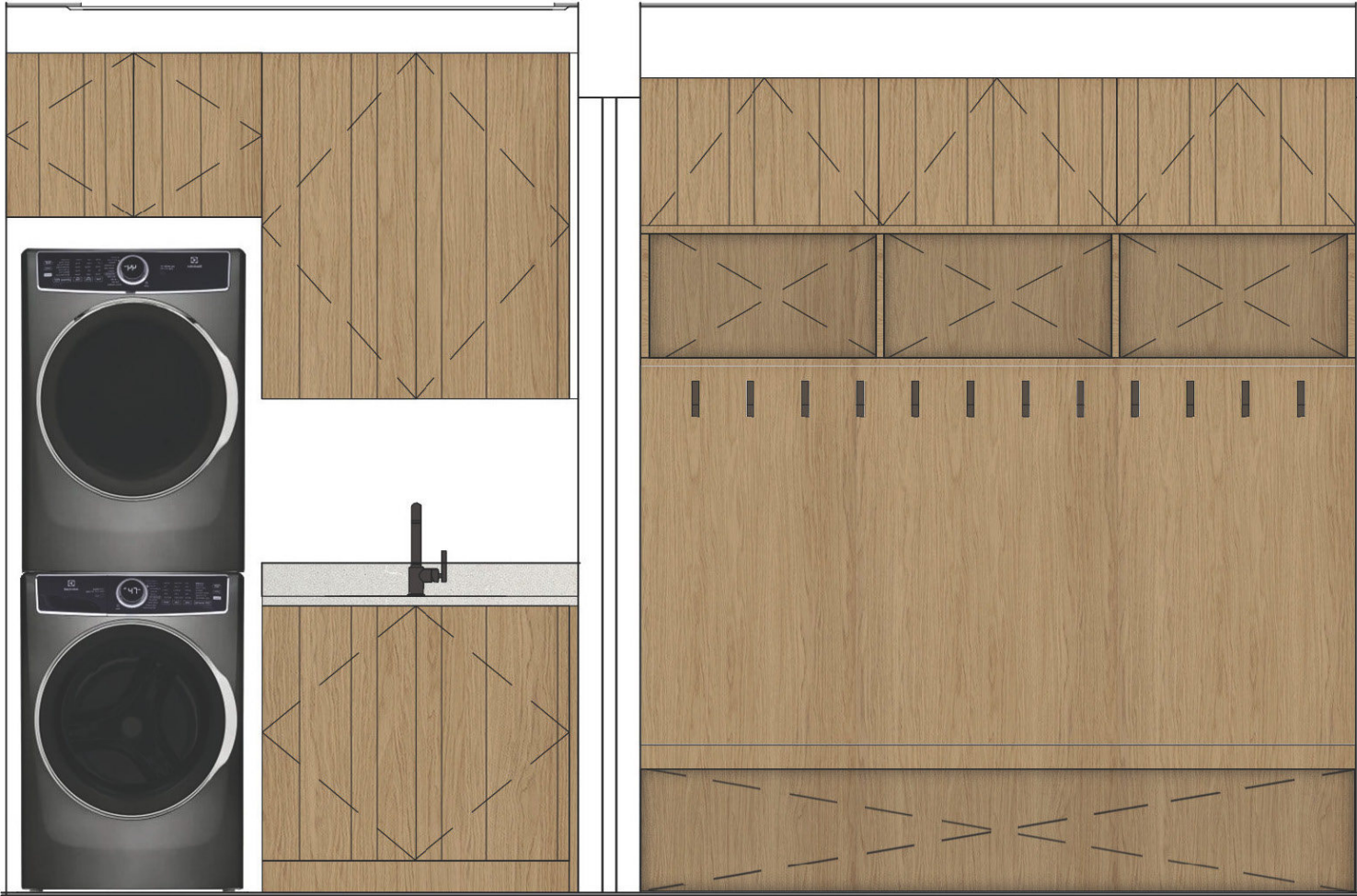

Elevations are examples for reference to illustrate finishes, but details vary by plan

Shared Finishes

Select A Finish Scheme for Finishes throughout Great Room, Kitchen and Bedrooms (from Cadence on Page 3 OR Tempo on Page 6)

Check here to Select >



WOOD FLOORING & WALL PANELING
Arrigoni Woods,
Rustic White Oak, Brushed,
Oyster Bay - 9.5"



WOOL CARPET
Fabrica
Inclination -
Flair



WOOL CARPET
Stark Irvine -
Pumice

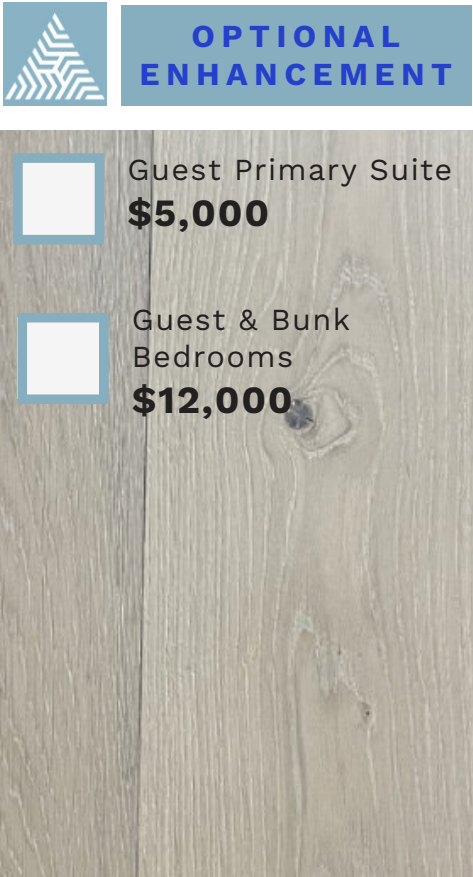

**REPLACE CARPET WITH
WOOD FLOORING**



WOOD CEILING
Arrigoni Woods -
Engineered Wood Panel
Spruce - Brushed
Natural Oil



BASEBOARD - STAINED WOOD
Straight Profile
Finish to Coordinate with Floors

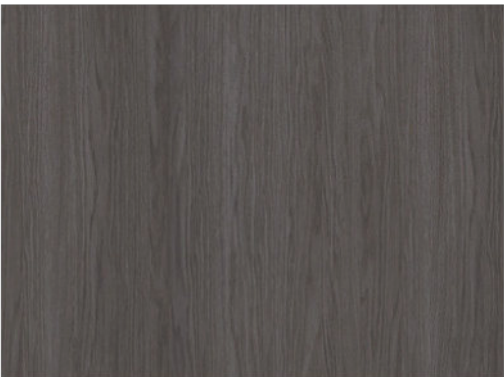

MILLWORK FINISH
Poliform
Olmo Nero Black Elm

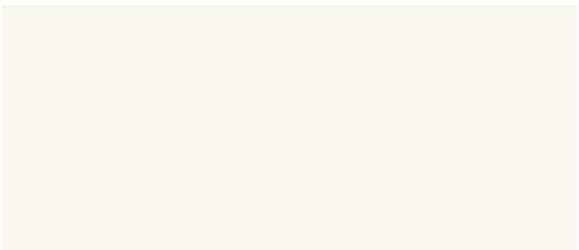

PAINT
Benjamin Moore
Cloud White
Walls - Eggshell, Ceiling - Flat



INTERIOR DOOR HARDWARE
FSB
Stainless Steel



DOOR STYLE
Slab Door and Extended Jamb
Character Grade White Oak,
Vertical Direction
Finish to Coordinate with
Floors & Wall Paneling



MILLWORK PANELING
Arrigoni, Rustic White Oak, Oyster Bay



FIREPLACE STONE & HEARTH
Karen Pearce Selden Marble,
Honed 3CM Slab



ACCENT STONE
Basaltina Honed and Filled, Basalt
3CM Slab



FIREPLACE
Dimplex Opti-Myst Pro
1000 Cassette



Elevations are examples for reference to illustrate finishes, but details vary by plan

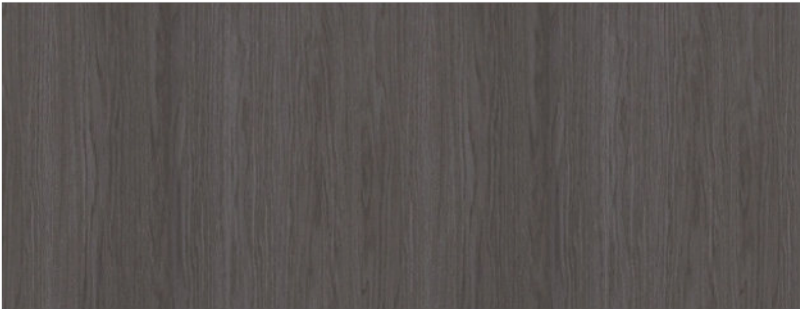

MILLWORK FINISH
Olmo Nero Black Elm



STONE FLOOR TILE
Tile Bar - Catalina Belgian
Bluestone 18" x 36"



QUARTZ COUNTERTOP
Statuario
Maximus Polished
3CM



ENTRY COAT HOOK
RMH - Jane Hook
Silicon Bronze
Dark



WORKSTATION SINK
Ruvati - Alto Utility
Sink



FAUCET
Waterworks
Matte Nickel



ENTRY FLUSH
MOUNT Allied Maker
- Dome Blackened
Brass



Elevations are examples for reference to illustrate finishes, but details vary by plan

Kitchen

Select A Finish Scheme (from Page 9 OR 10; Tempo on Following Page)

Check here to Select >



COUNTERTOP
Karen Pearse - Carthage Quartzite
Honed - 3CM



Check here
to Select >



BACKSPLASH OPTION 1
Karen Pearse - Carthage Quartzite
Honed - 3CM

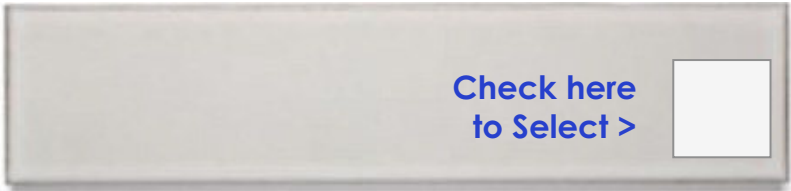

Check here
to Select >



BACKSPLASH OPTION 2
Ann Sacks - Savoy Linen
3" x 12"

*If selected, hood surround to be wood paneling to match cabinets
in lieu of stone slab



CABINETRY
POLIFORM
Rovere Gold Oak



CABINET STYLE
Artex Carved Line
Rovere Gold



PENDANT
Roll & Hill -
Endless Bronze



KITCHEN FAUCET FINISH
Waterworks -
Matte Brown

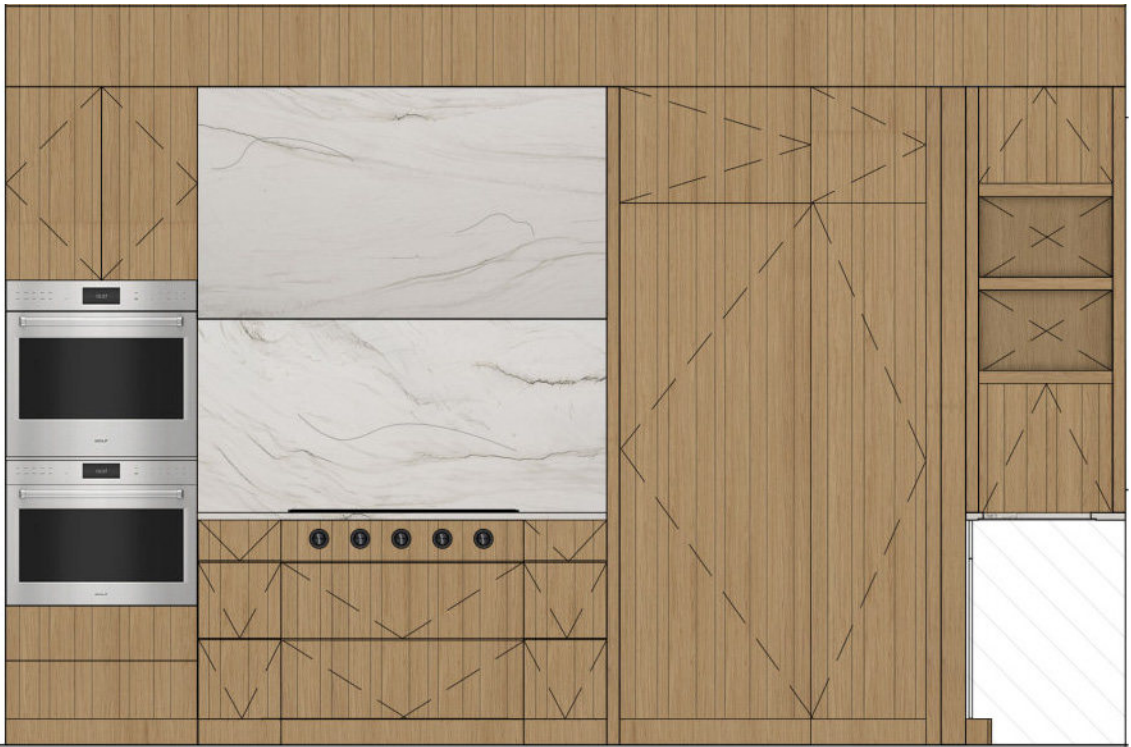
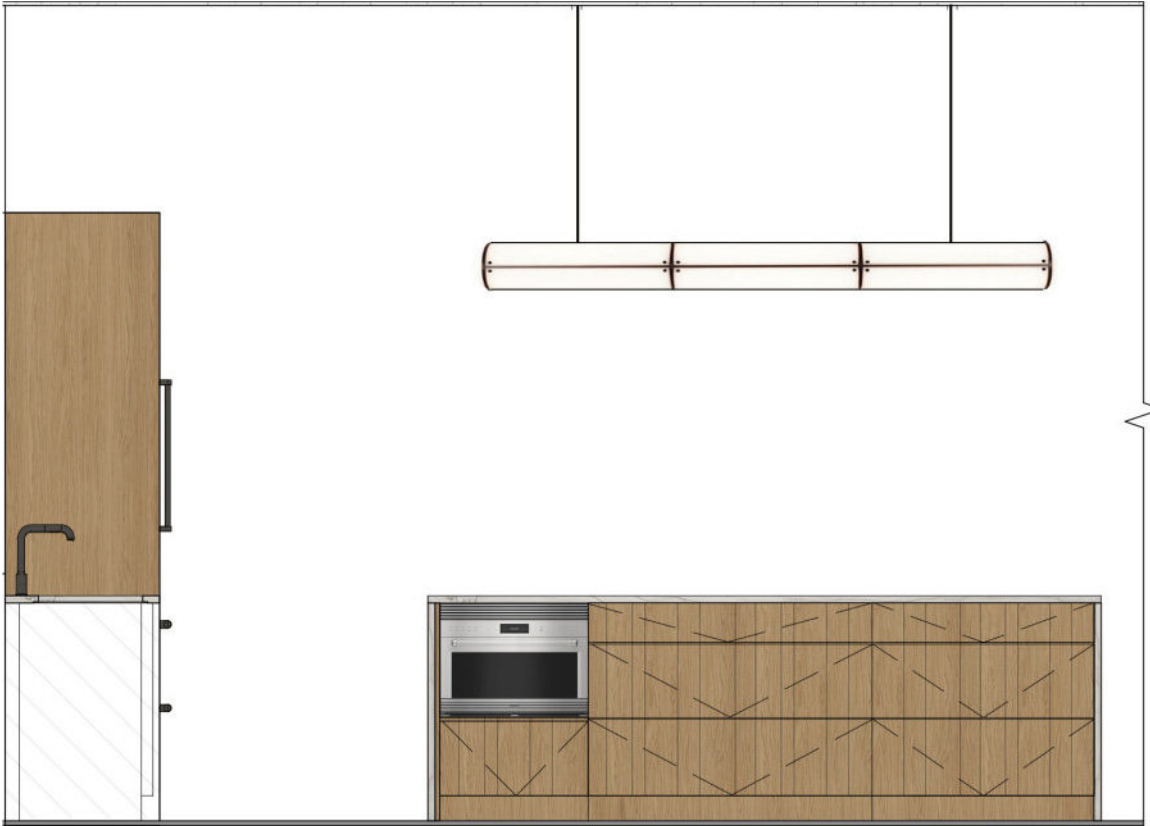

Elevations are examples for reference to illustrate finishes, but details vary by plan

Kitchen

Select A Finish Scheme (from Page 9 OR 10; Cadence on Previous Page)

Check here to Select >



COUNTERTOP
Decorative Materials
Adamantium Quartzite Slab - Honed - 3CM



BACKSPLASH OPTION 1
Decorative Materials
Adamantium Quartzite Slab - Honed - 3CM

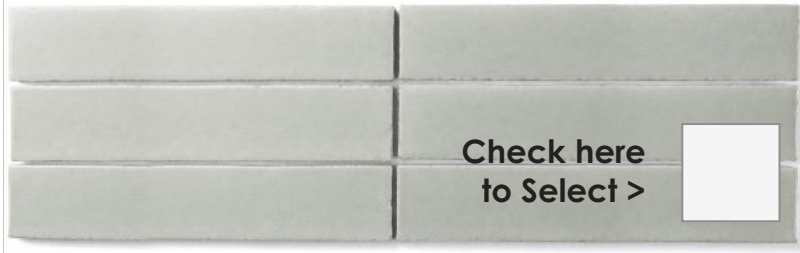

BACKSPLASH OPTION 2
Fireclay - Elk Brick
Tile 2.5” x 11.5”

*If selected, hood surround to be wood paneling to match cabinets in lieu of stone slab

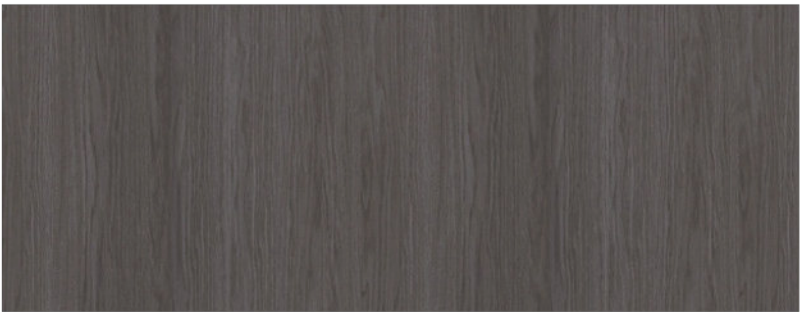

CABINETRY
POLIFORM
Olmo Nero Black Elm



CABINET STYLE
Artex Carved Line
Olmo Nero Black Elm



PENDANT
Roll & Hill -
Endless Black



KITCHEN FAUCET FINISH
Waterworks -
Matte Nickel



Elevations are examples for reference to illustrate finishes, but details vary by plan

Primary Bathroom

Select A Finish Scheme (from Page 11 OR 12; Tempo on Following Page)

Check here to Select >

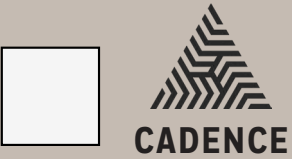

WALL TILE & SHOWER CEILING
Decorative Materials - Arabescato
D'Oro 12"x24" and 1/2"x4" Mosaic



STONE COUNTERTOP
Decorative Materials - Arabescato
D'Oro Honed 2CM



VANITY FINISH
Rovere Gold Oak



PORCELAIN FLOOR TILE & SHOWER FLOOR
TILE Decorative Materials - Buff Stonework
Honed 12" x 24"



SCONCES
Fuse - Vizcaya Oil
Rubbed Bronze



WIDESPREAD FAUCET
Waterworks Matte
Brown



UNDERMOUNT SINK
Toto - White



Elevations are examples for reference to illustrate finishes, but details vary by plan



TUB FAUCET
Waterworks
Matte Brown



FREE STANDING BATHTUB
Victoria + Albert - Eldon
White Porcelain



STEAM UNIT
Mr. Steam
Black



SHOWER HEAD
Waterworks
Matte Brown



CONTROL VALVE
Waterworks
Matte Brown



TOILET
Toto RP Wall
Hung Toilet -
Cotton



HANDSHOWER
Waterworks
Matte Brown

Primary Bathroom

Select A Finish Scheme (from Page 11 OR 12; Cadence on Previous Page)

Check here to Select >

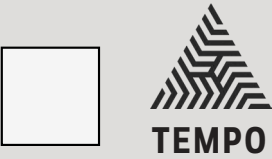

WALL TILE AND SHOWER CEILING
Tile Bar - Salazar Marble
12"x24"



STONE COUNTERTOP
Tile Bar - Salazar Marble Honed
3CM



VANITY
Olmo Nero Elm



PORCELAIN FLOOR & SHOWER FLOOR TILE
Decorative Materials - Buff Stonework
Honed 12" x 24"



SCONCES
Roll & Hill
Counterweight
Ash/Marble



WIDESPREAD FAUCET
Waterworks
Matte Nickel



UNDERMOUNT SINK
Toto - White



Elevations are examples for reference to illustrate finishes, but details vary by plan



TUB FAUCET
Waterworks
Matte Nickel



FREE STANDING BATHTUB
Victoria + Albert - Eldon White
Porcelain



STEAM UNIT
Mr. Steam
White



SHOWER HEAD
Waterworks
Matte Nickel



CONTROL VALVE
Waterworks
Matte Nickel



TOILET
Toto RP Wall
Hung Toilet -
Cotton



HANDSHOWER
Waterworks
Matte Nickel

Primary Bedroom Fireplace

Select A Finish Scheme (from Page 13 OR 14; Tempo on Following Page)

[Check here to Select >](#)

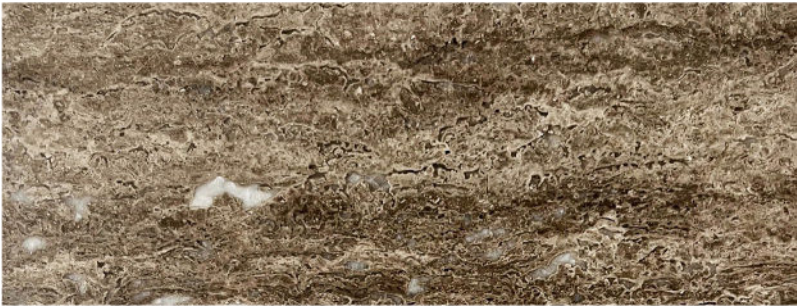

FIREPLACE STONE
Thorn tree Didima Dark,
Honed 3CM Slab



WALL PANELING
Arrigoni, European White Oak, Arolla



MILLWORK FINISH
Rovere Gold Oak



FIREPLACE
Dimplex Opti-Myst Pro 1000
Cassette



Elevations are examples for reference to illustrate finishes, but details vary by plan

Primary Bedroom Fireplace

Select A Finish Scheme (from Page 13 OR 14; Cadence on Previous Page)

Check here to Select > ☐

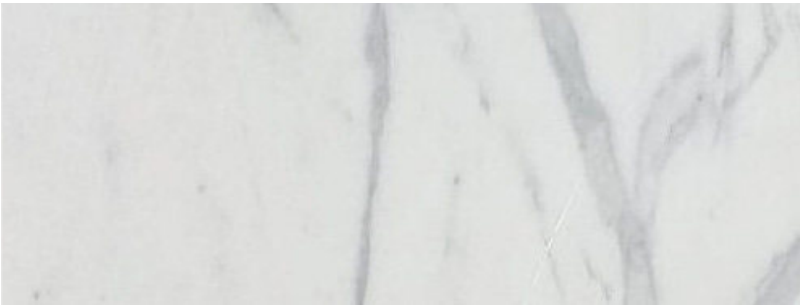

FIREPLACE STONE
Karen Pearse Selden Marble,
Honed 3CM Slab

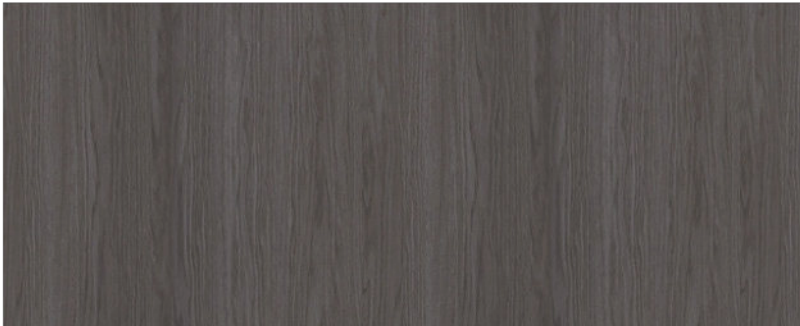

MILLWORK FINISH
Olmo Nero Black Elm



WALL PANELING
Arrigoni, European White Oak, Oyster Bay



FIREPLACE
Dimplex Opti-Myst Pro
1000 Cassette



Elevations are examples for reference to illustrate finishes, but details vary by plan

Guest Primary Bathroom

Select A Finish Scheme (from Page 15 OR 16; Tempo on Following Page)

Check here to Select >

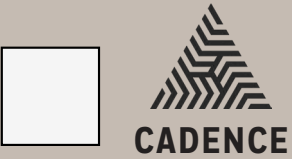

WALL TILE
Ann Sacks - Savoy
Driftwood 6" x 6"



COUNTERTOP
Decorative Materials - Arabescato
D'Oro Honed 2CM



VANITY
Rove ~~FINISH~~ Oak



PORCELAIN FLOOR & SHOWER FLOOR TILE
Decorative Materials - Buff Stonework
Honed 12" x 24"



Elevations are examples for reference to illustrate finishes, but details vary by plan



SCONCE
Fuse - Montecito
Woven Stainless +
Jute Oil Rubbed
Bronze



FAUCET
Waterworks
Matte Brown



UNDERMOUNT SINK
Toto - White



CONTROL
VALVES
Waterworks
Matte Brown



SHOWER HEAD
Waterworks
Matte Brown



TOILET
Toto Aqua -
White

Guest Primary Bathroom

Select A Finish Scheme (from Page 15 OR 16; Cadence on Previous Page)

Check here to Select > 



WALL TILE
Rookwood - Mushroom 6" x 6"



STONE COUNTERTOP
Tile Bar - Salazar
Marble Honed 3CM

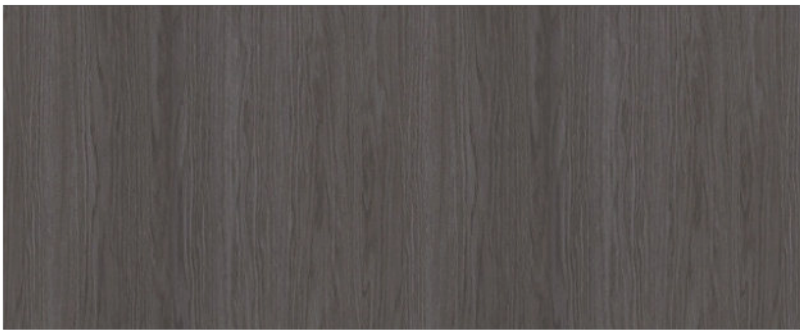

VANITY
Olmo NE Finish
Black Elm



STONE FLOOR TILE
Tilebar - Seagrass
Limestone Flamed
24" x 24"



Elevations are examples for reference to illustrate finishes, but details vary by plan



SCNCE
Fuse - Montecito
Woven Stainless +
Jute Satin Nickel



FAUCET
Waterworks
Matte Nickel



UNDERMOUNT SINK
Toto - White



SHOWER HEAD
Waterworks
Matte Nickel



CONTROL VALVES
Waterworks
Matte Nickel



TOILET
Toto Aquia - White

Guest Bathroom

Select A Finish Scheme (from Page 17 OR 18; Tempo on Following Page)

[Check here to Select >](#)



WALL TILE
Stone Source - Cooperative
Limestone White - 15" x 30"



QUARTZ COUNTERTOP
Fresh Concrete Honed
3CM



VANITY FINISH
Rovere Gold Oak

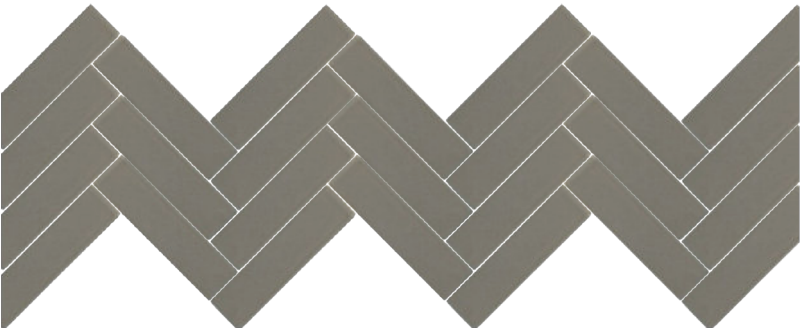

FLOOR TILE
Rookwood - Bungalow
Herringbone Pattern - 2"x 8"



SCNCE
Roll & Hill -
Modo Bronze



FAUCET
Waterworks
Matte Brown



UNDERMOUNT SINK
Toto - White



Elevations are examples for reference to illustrate finishes, but details vary by plan



SHOWERHEAD
Waterworks
Matte Brown



CONTROL VALVES
Waterworks
Matte Brown



TOILET
Toto Aqua -
White

Guest Bathroom

Select A Finish Scheme (from Page 17 OR 18; Cadence on Previous Page)

Check here to Select >

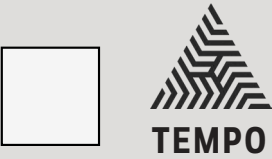

WALL TILE
Thorntree - Ria Alvor
Light 15" x 30"

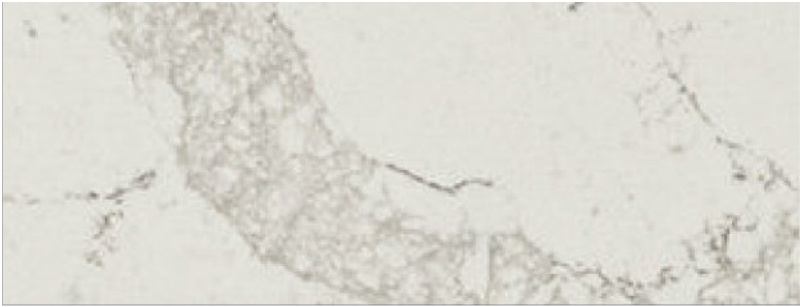

QUARTZ COUNTERTOP
Statuario Maximus Polished
3CM



VANITY
Olmo ~~NE~~ack Elm

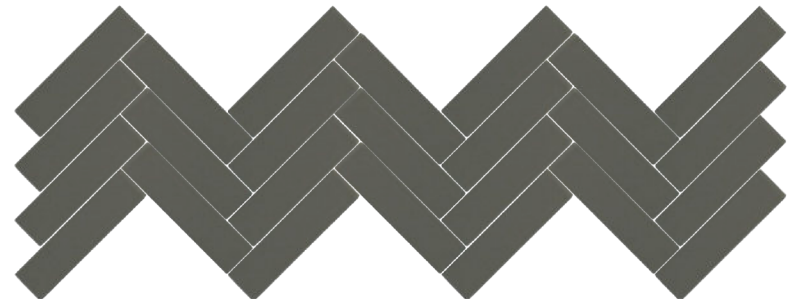

FLOOR TILE
Rookwood - Mineral
Herringbone Pattern - 2"x 8"

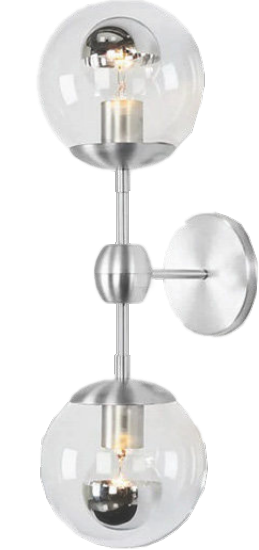

SCONCE
Roll & Hill -
Modo Polished
Nickel



FAUCET
Waterworks
Matte Nickel



UNDERMOUNT SINK
Toto - White



Elevations are examples for reference to illustrate finishes, but details vary by plan



SHOWER HEAD
Waterworks
Matte Nickel



CONTROL VALVES
Waterworks



TOILET
Toto Aqua - White

Bunk Bathroom

Select A Finish Scheme (from Page 19 OR 20; Tempo on Following Page)

[Check here to Select >](#)

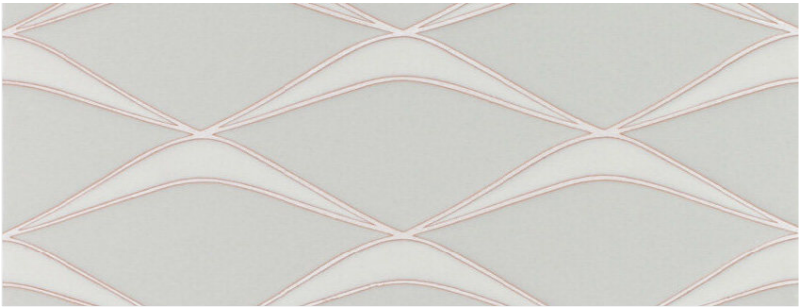

WALL & FACE OF TUB TILE
Fireclay - Uni Mountain, Neutral
6" x 12"



QUARTZ COUNTERTOP
Fresh Concrete
3CM



VANITY
Rove ~~FINISH~~ Oak



PORCELAIN FLOOR TILE
Stone Source - Bay Pave Matte
6.5" x 9"



SCONCE
Visual Comfort
Precision Bath
Light Bronze



FAUCET
Waterworks
Matte Brown

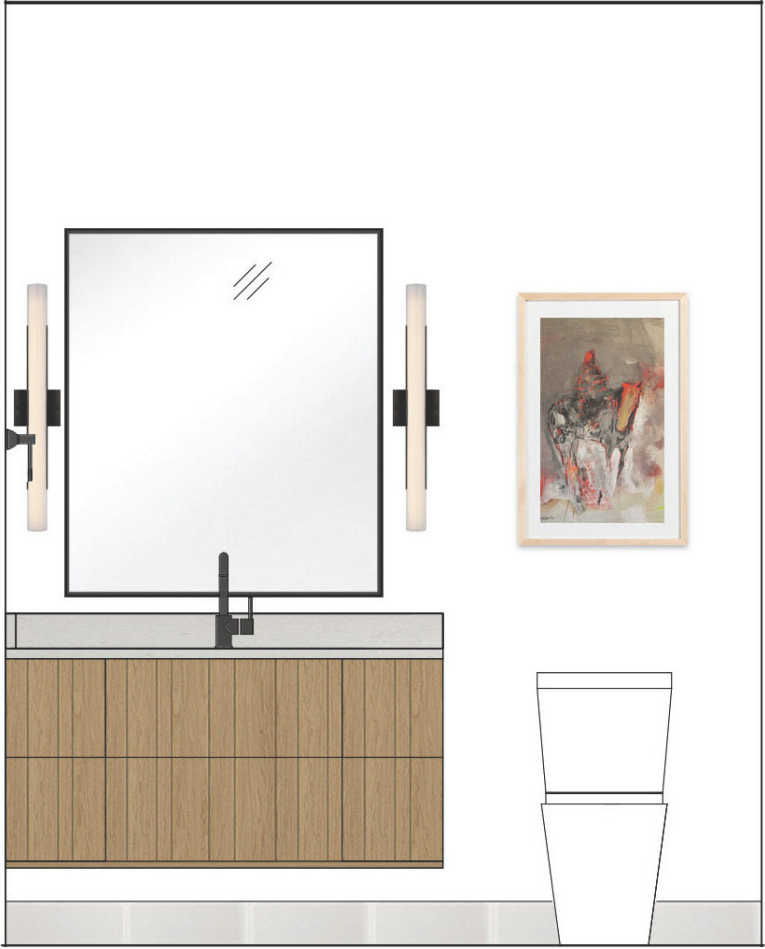
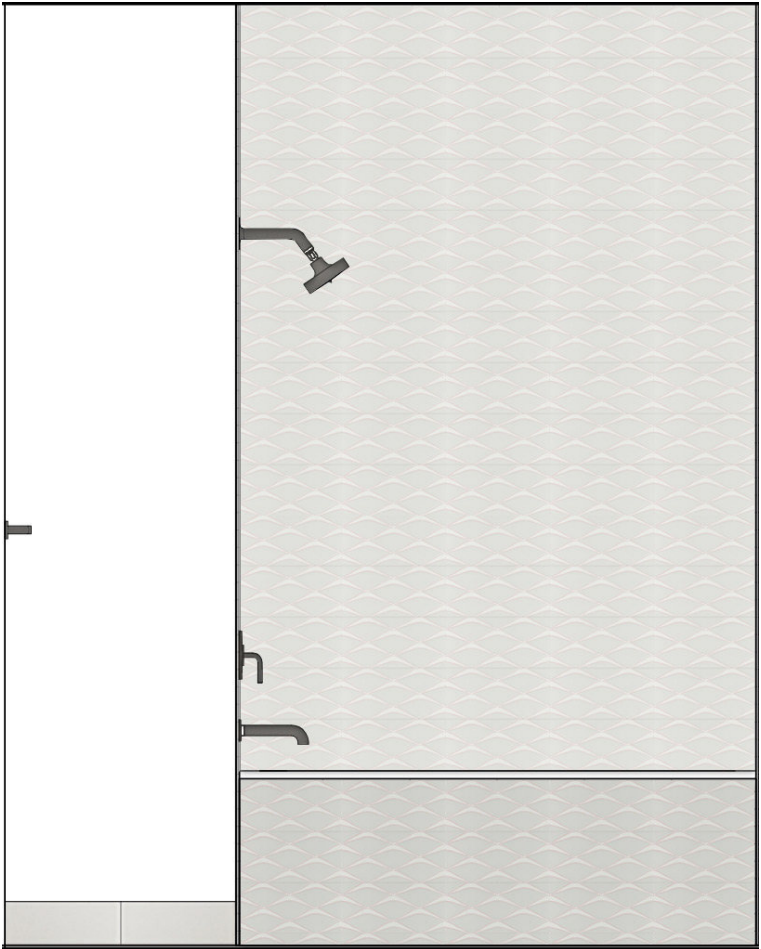

Elevations are examples for reference to illustrate finishes, but details vary by plan



TUB SPOUT
Waterworks
Matte Brown



SHOWER HEAD
Waterworks
Matte Brown



UNDERMOUNT SINK
Toto - White



ALCOVE TILE FRONT
TUB Kohler Archer -
60"



TUB/SHOWER CONTROLS
Waterworks
Matte Brown

Bunk Bathroom

Select A Finish Scheme (from Page 19 OR 20; Cadence on Previous Page)

Check here to Select >

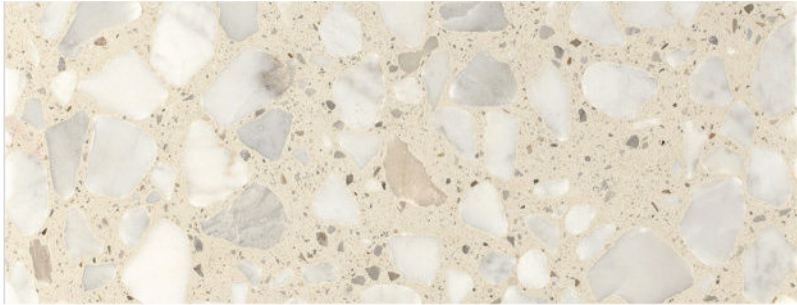
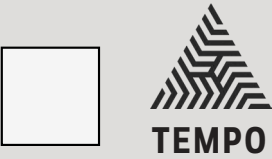

WALL & FACE OF TUB TILE
DDS - Aggregato Terrazzo Forte Trinia
Honed 16" x 32"

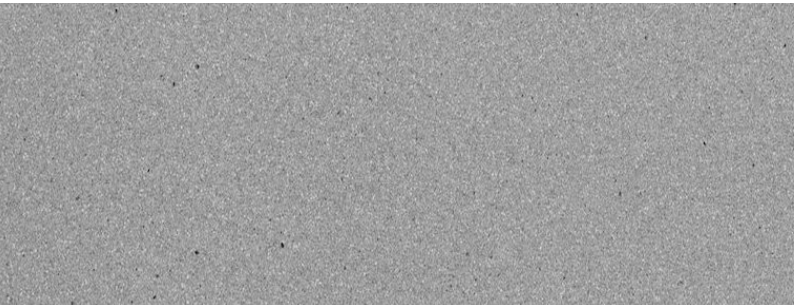

QUARTZ COUNTERTOP
Sleek Concrete
3CM

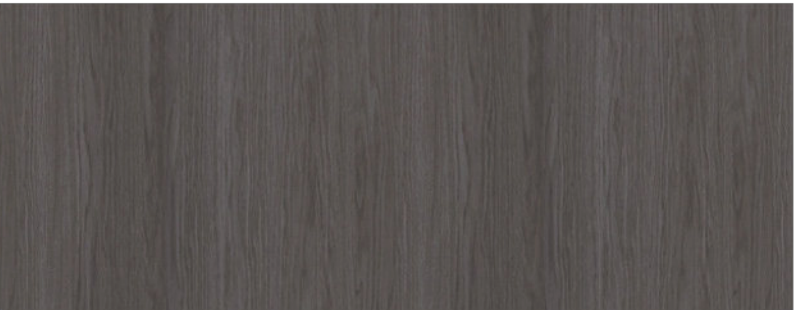

VANITY
Olmo NERO FINISH
Black Elm

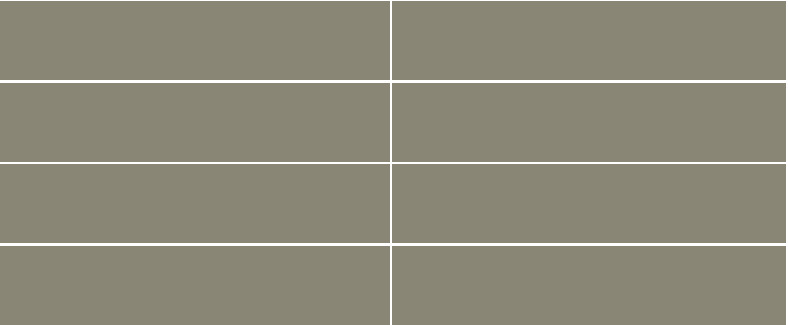

PORCELAIN FLOOR TILE
Ann Sacks - Colore
Stone 2" x 10"



SCONCE
Visual Comfort
Precision Bath
Light Polished
Nickel



FAUCET
Waterworks

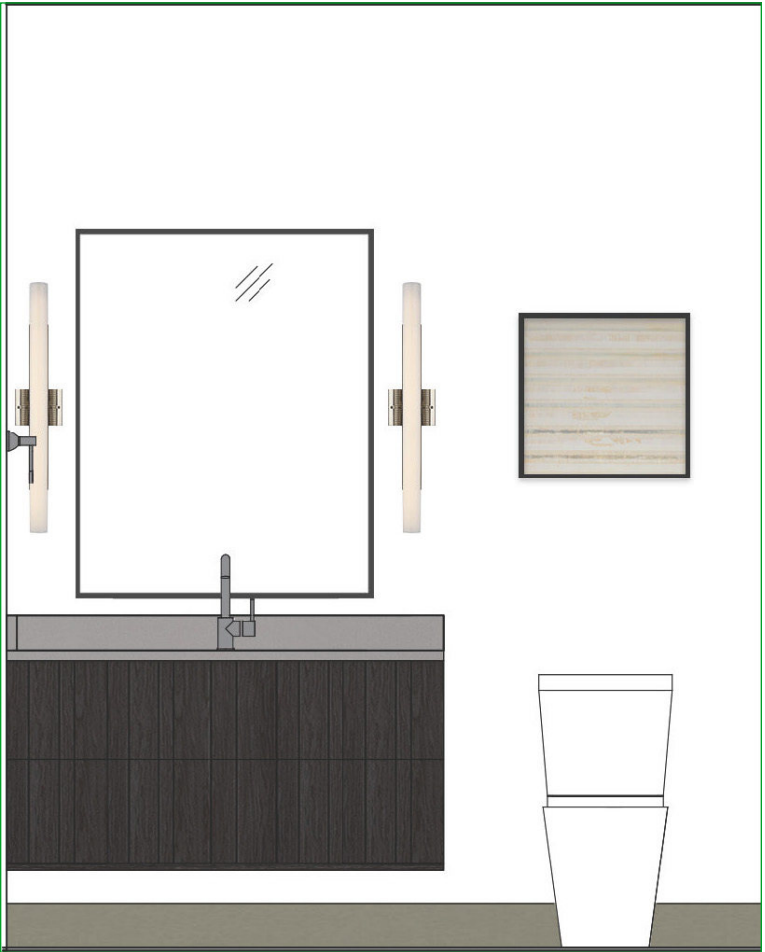
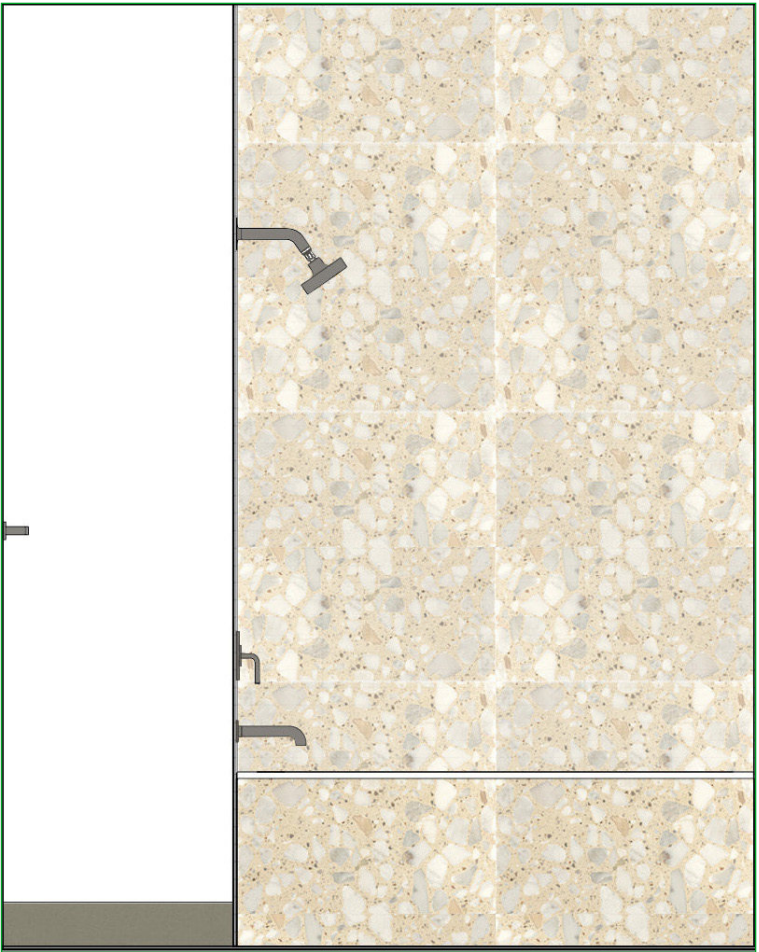

Elevations are examples for reference to illustrate finishes, but details vary by plan



TUB SPOUT
Waterworks
Matte Nickel



SHOWER HEAD
Waterworks
Matte Nickel



UNDERMOUNT SINK
Toto - White



ALCOVE TILE FRONT TUB
Kohler Archer - 60"



TUB/SHOWER CONTROLS
Waterworks
Matte Nickel

Powder Bathroom

Select A Finish Scheme (from Page 21 OR 22; Tempo on Following Page)

[Check here to Select >](#)

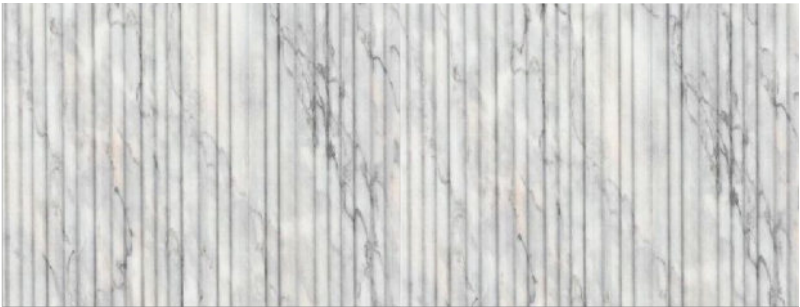

HALF TILE WALL
Waves White Lion Fluted 3D Honed
Marble 12” x 24”



MARBLE COUNTERTOP
Cardinal - Honed - 2CM



FLOORING
Arrigoni, Rustic White Oak, Arolla



WOOD ACCENT WALL
Arrigoni, Rustic White Oak,
Arolla



SCONCES
Allied Maker - Brass
T2 Bronze



*Elevations are examples for reference to
illustrate finishes, but details vary by plan*



WALL FAUCET
Waterworks
Matte Brown



UNDERMOUNT SINK
Toto - White



TOILET
Toto RP Wall
Hung Toilet -
Cotton

Powder Bathroom

Select A Finish Scheme (from Page 21 OR 22; Cadence on Previous Page)

[Check here to Select >](#)

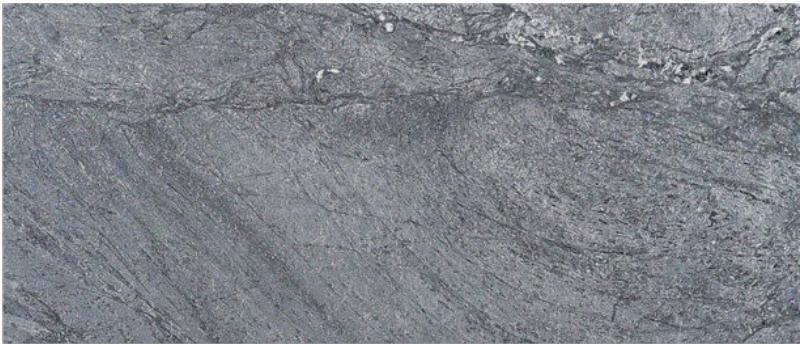

SOAPSTONE COUNTERTOP
Karen Pearse - Reservoir,
Honed 2CM



WOOD ACCENT WALL
Arrigoni, Rustic White Oak,
Oyster Bay



WOOD FLOORING
Arrigoni, Rustic White Oak, Oyster Bay



SCONCES
Allied Maker - Brass
T2 Nickel



WALL FAUCET
Waterworks
Matte Nickel



UNDERMOUNT SINK
Toto - White



TOILET
Toto RP Wall
Hung Toilet -
Cotton

Elevations are examples for reference to
illustrate finishes, but details vary by plan



WASHLET TOILET IN LIEU OF TYPICAL TOILET AT PRIMARY BATHROOM

☐ \$6,700



TOTO
RP Washlet
Available In Primary Bathroom Only



WASHLET TOILET IN LIEU OF TYPICAL TOILET

\$7,200 per bathroom

- Guest Primary ☐
- Guest Bathroom ☐
- Bunk Bathroom ☐
- Powder Bathroom ☐



TOTO
Neorest AS
Dual Flush w/ Washlet
***Available In Secondary
Bathrooms***



ADD GLASS ENCLOSURE AT GUEST BATHROOM TUB

☐ \$3,000



ELECTRICAL: OPTIONAL ENHANCEMENTS



ELECTRIC LIT MIRROR IN LIEU OF SCONCES AND TYPICAL MIRROR AT PRIMARY BATHROOM

☐

No Cost



ADD USB CHARGING OUTLETS AT KITCHEN BACKSPLASH AND BEDROOM HEADBOARD WALLS

Select box that corresponds with your floorplan

☐

4 Bedroom
\$1,400

☐

5 Bedroom
\$1,700



ADD HOT TUB

\$34,000

Sky Cabins 618, 701, 703, 705, 718
Nordic
ENCORE MS

\$22,500

Sky Cabin 612
Nordic
STELLA MS

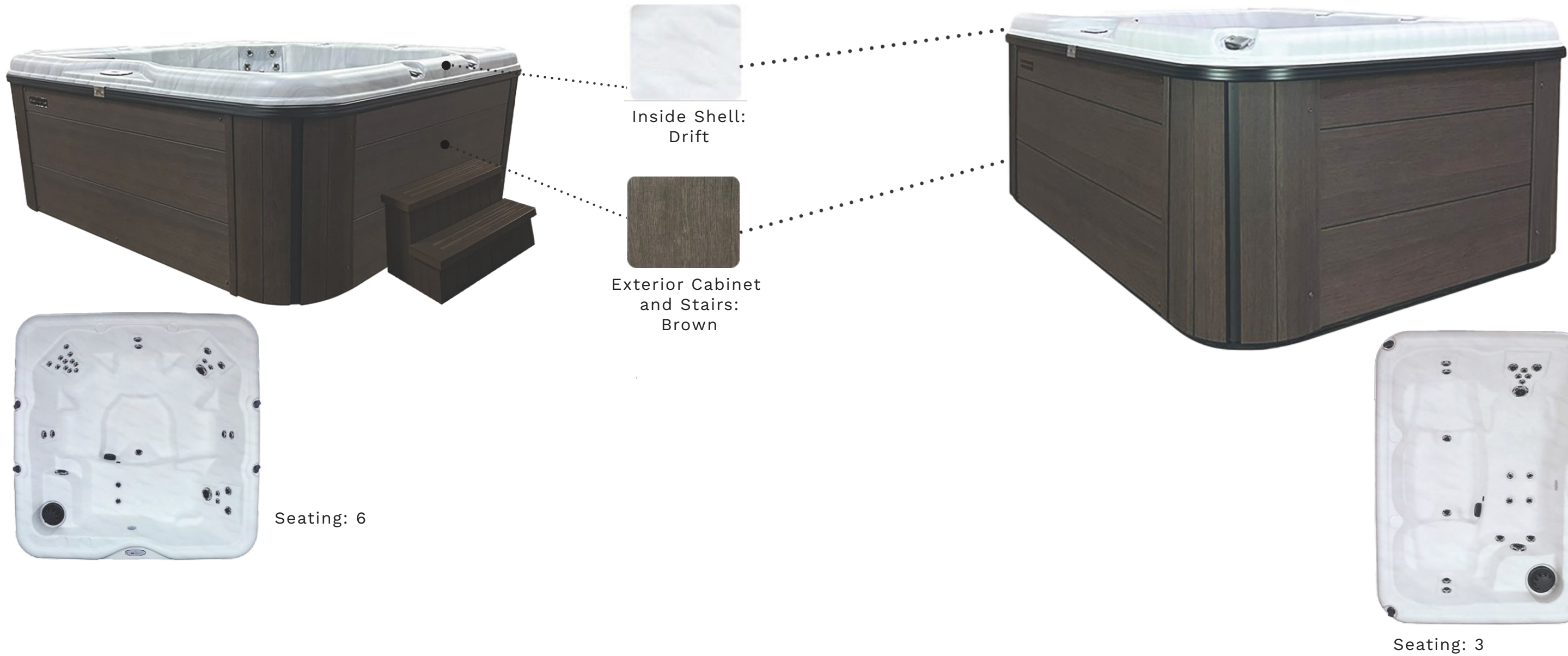

* At select units/locations only. Refer to floor plans for residence location. Cost includes hot tub, installation, electrical connections, and start up. HOA is not responsible for any hot tub maintenance or repairs. All maintenance and operating costs are the responsibility of the Unit owner.

Sky Cabin #: _____

Item	Cost
Wood Flooring in Lieu of Carpet	\$
Washlet Toilet at Primary Bathroom	\$
Washlet Toilet(s) at Secondary Bathroom(s)	\$
Glass Enclosure at Guest Tub	\$
USB Outlets at Kitchen and Headboard Walls	\$
Hot Tub	\$
OPTIONAL ENHANCEMENTS PRICE:	\$

Optional Enhancement selections are final and binding. Purchaser acknowledges that the pricing contains all costs associated with the enhancements, including but not limited to hard costs, drawing documentation, insurances, warranty, contingency, overhead and management. The Enhancements Price is in addition to the Purchase Price and due and payable to Seller at Closing.

Purchaser Acknowledgment (Initials):_____

Once this document is mutually signed by Purchaser and Seller, the Plans and Specifications for the Unit shall be deemed automatically updated to include the finish selections and optional enhancements indicated above. No change to the selections or optional enhancements by Purchaser are permitted unless accepted by Seller in its sole, absolute discretion as evidenced by Seller's acknowledgment on a new selection form. Purchaser understands that Seller can refuse to accept any new form submitted by Purchaser for any reason or no reason, in which event this selection shall remain binding.

As further described in Purchaser's Purchase and Sale Agreement, Seller reserves the right to make modifications to the materials and fixtures due to unavailability or unreasonable delivery delays. Such substitutions may be made without notice.

If the Unit is owned by multiple owners or by an entity, the undersigned represents and warrants that they have full authority to bind the owner(s) of the Unit to these finish selections and optional enhancements.

PURCHASER

SELLER ACKNOWLEDGMENT

Name:_____

Signature:_____

Signature:_____

Date: _____

Date: _____

NOTE: Artist conceptual renderings, colored perspectives, floorplans and elevations used herein are intended solely for illustrative purposes and may not accurately represent the details of each specific unit. This package does not represent all finishes within the unit. Please refer to the Plans and Specifications for additional materials and details. Color and grain variations are natural characteristics of all wood, tiles, stone, and marbles. No two pieces will ever look exactly alike and we cannot ensure exact matching of related pieces or images shown. Images herein may not depict the full variation of color or pattern for each material. It is recommended that you refer to the manufacturer websites for additional photos and product details to ensure you understand the selected materials.